



## SilkFP-101TA

### Time Attendance Terminal

With innovative fingerprint verification algorithm, the SilkID fingerprint reader processes quick and precise identification of wet,

dry and rough fingers. Infrared sensation technology enables accurate fingerprint sensing and auto-activation to save power.

---

## Features

- Latest SilkID Fingerprint Reader precisely identifies wet, dry and rough fingerprints
- Infrared Auto fingerprint sensation and activation to save power
- Good operation under strong light source with Anti-glare technique
- Fits with Governmental facilities, factories, construction sites, financial bodies and institutional facilities

# Specifications

Fingerprint Capacity	3000
ID Card Capacity	10,000 (Optional)
Record Capacity	100,000
Display	2.8-inch TFT Screen
Communication	TCP/IP, USB(Host and Client)
Standard Functions	Webserver, Work Code, SMS, DST, Scheduled-bell, Self-Service Query, Automatic Status Switch, T9 Input, 9 digit user ID, Photo ID
Optional Functions	ID/Mifare, Wi-Fi, External Bell, ADMS
Power Supply	DC 5V 0.8A
Operating Temp.	0°C - 45°C
Operating Humidity	20% - 80%
Dimension	192.0×140.0×42.5mm (Length×Width×Thickness)
Package Weight	1.05 kg

## Configuration

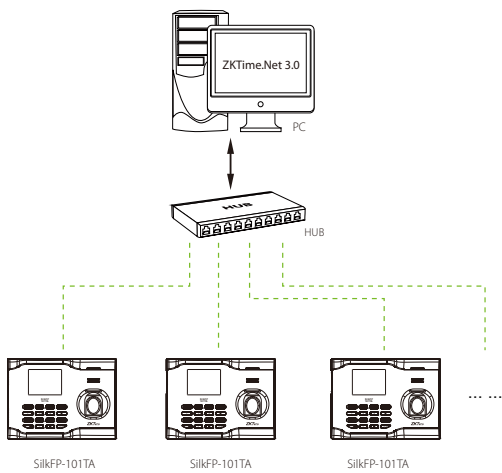

## What's in the Box

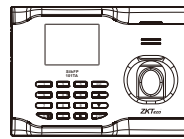

SilkFP-101TA

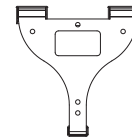

Back Plate

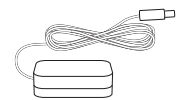

Power Adapter

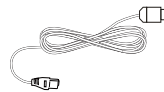

USB Cable

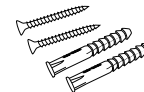

Screws and Holders