

UHF 6Pro Series

18m Ultra-Long Range RFID Reader Longer Distance, Better Experience



UHF 6Pro is a high-performance long-distance RFID reader. It is configured with Impinj R2000 chip and waterproof casing. It has stable performance, long service life, minimized external interference and upgraded long reading distance. Therefore, it can be applied in many remote identification fields.

Features

- High-performance Impinj R2000 chip
- Two working mode: Read Always (Default) & Read by Trigger
- Reading distance up to 18m (adjustable)
- Wiegand 26-Bit (can change to 34-Bit via software)

Applications



Long distance fixed vehicle access management



Non-contact access control management

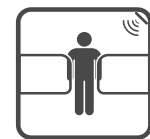

Long distance pedestrian access management

Specifications

Model	UHF 6E Pro	UHF 6F Pro
Reading Distance	Up to 18 meters (adjustable)	
Frequency	865MHz ~ 868MHz	902MHz ~ 928MHz
Communication Interface	Wiegand 26(Default) /Wiegand 34, USB	
Chip	Impinj R2000	
Interface Protocol	EPCglobal UHF Class 1Gen2/ ISO 18000-6C, ISO 18000-6B	
Working Mode	Always read(Default) / Trigger read	
Output Power	10dBm ~ 33dBm	
Antenna Gain	9dBi	
Shell Material	Antenna Panel: ABS Plastics; Back Cover: Die-cast Aluminum Shell	
Working Voltage	DC9V ~ 12V	
Working Current	1.2A +/-10%	
Working Temperature	-20 °C - 60 °C	
Dimension	310mm*310mm*90mm (±5mm)	

Topology Diagram

Long distance fixed vehicle access management

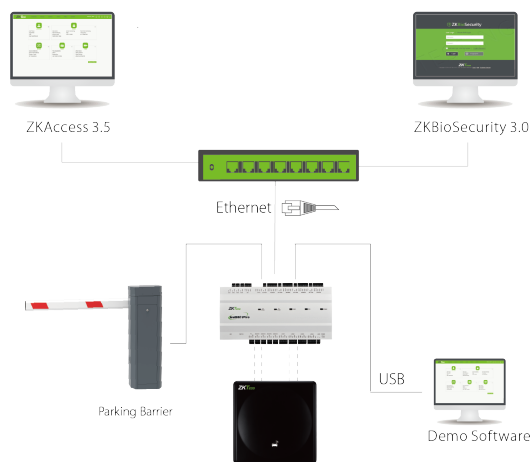

Non-contact access management

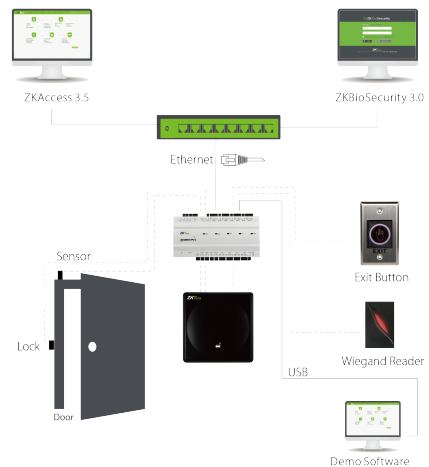

Related Product



Access Controller



UHF Fixed Column



Parking Barrier



Electric Lock

V1.0 2018.07.10