

# NFT Blizzard 2ac-90

A 2.4/5GHz Dual-Radio 802.11ac Outdoor Sector Access Point



## NFT Blizzard 2ac-90

The NFT Blizzard 2ac-90 is an outdoor Wi-Fi access point that utilizes the 802.11ac technology and integrated 2.4/5GHz 2x2 MIMO radios, boasting 29dBm of transmit power.

The device's gigabit Ethernet port with 802.3af/at support allows users to power up the device using PoE switches. The NFT Blizzard 2ac-90 is specifically designed for cost-efficient, yet professional outside hotspot scenarios. The IP67-rated casing, integrated surge protection, and easy-to-use pole mounting ensure an effective and inexpensive solution for various applications, including public Wi-Fi, education, hospitality, retail, dining venues, and many more.

---



## Infinity Controller

The Infinity Controller is an intuitive product and network management platform for your NFT devices. It allows easy, simple, and fast network installation, configuration, and control, all of which can be performed using a web browser. The Controller also facilitates network maintenance and expansion by automating these processes. The management platform can function as an integrated controller or as an external one (i.e. Infinity Cloud Controller), thus serving as an optimal solution for setting up and managing networks of any size.



## Automated Device Onboarding

Automated device onboarding (ADO) is the process of automatically setting up Infinity access points that are introduced to the network. Not only does ADO eliminate the discrepancies caused by manual setup, but it also simplifies the deployment process and saves valuable time.

Automated device onboarding requires one-time configuration of the Cloud AP, after which the settings are automatically applied to all Infinity access points that are newly-connected to the network using a physical connection.



## Flexible Network Scaling

The External Infinity Controller is designed with various types of networks in mind, whether they contain just a few access points or thousands of them.

Networks can be categorized into different logical groups (up to 4 layers) based on geographical location, service type, company branch, or other criteria. Each group can have different configurations assigned to them and access points can easily migrate between networks.

Furthermore, the External NFT Controller (installed on customer premises) supports multiple organizations simultaneously (many network owners).



## Pay as You Grow

A cloud-based Infinity Controller account is free and supports a network of up to 10 Infinity wireless access points, but can be expanded as the business grows. Learn more about the paid version [here](#).



## Predefined Scenarios for Your Applications

The Infinity Controller provides an array of features, collectively forming the optimal solution for multiple scenarios, e.g. a complete any-size office access point network, small café or shop hotspot, and an Easy Mesh application, which is popular among small hotels, schools, and hospitals.



## IP Session Logging

Infinity access points allow users to track and log end-user credentials (source/destination IPs and ports, MAC address, etc.) on the Internet, thus allowing a safer and transparent Internet service.



## Easy Mesh

Easy Mesh is LigoWave's solution to wireless network coverage expansion and device configuration automation. This feature is designed for the NFT Series (as well as DLB devices utilizing NFT firmware) and is only available on the External Infinity Controller.

The Infinity Controller allows users to set up an Easy Mesh network in a plain and simple way: just have at least one LAN-connected AP, create a new Easy Mesh network, assign devices to it, and you are good to go!



## Proximity

LigoWave access points have an integrated mobile device detection feature. This means that any device within range can be logged using the MAC address and date/time without any user interaction.

The data is exported in real time and can be used to improve the services of an enterprise or managed service provider by importing them into proprietary applications for analytics and insights. An API is available upon request.

Several of LigoWave's technological partners are already using this functionality. For more information, go to the LigoWave Technological Partners page at [ligowave.com/technological-partners](https://ligowave.com/technological-partners).

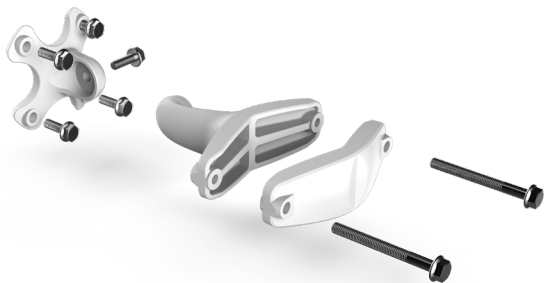

## Professional Pole Mounting

The NFT Blizzard 2ac-90 has a professional metal mounting bracket, designed for assembly and installation on poles.

It consists of easy-to-connect parts that allow robust mounting and precision tilting.

The design includes additional reinforcements and strong materials to ensure resilience in extreme climate conditions.

## Technical Specifications

### Wireless

WLAN Standard	IEEE 802.11a/b/g/n/ac
Radio Mode	Dual 2×2 MIMO
Operation Mode	Access Point, Repeater
Radio Frequency Band	2.402–2.482GHz (Country-Dependent) 5.150–5.850GHz (Country-Dependent)
Transmit Power	2.4GHz: 29dBm @ MCS0; 5GHz: 29dBm @ MCS0;
Channel Size	20, 40, 80MHz
Modulation Schemes	802.11ac: OFDM (256-QAM, 64-QAM, 16-QAM, QPSK, BPSK) 802.11a/g/n: OFDM (64-QAM, 16-QAM, QPSK, BPSK) 802.11b: DSS (CCK, DQPSK, DBPSK)
Data Rates	802.11ac @ 80MHz: 866, 780, 650, 585, 520, 390, 260, 195, 130, 65Mbps 802.11n @ 40MHz: 300, 270, 240, 180, 120, 90, 60, 30Mbps 802.11a/g @ 20MHz: 54, 48, 36, 24, 18, 12, 9, 6Mbps 802.11b @ 20MHz: (11, 5.5, 2, 1Mbps)
Duplexing Scheme	Time Division Duplex
Wireless Security	WPA/WPA2 (TKIP/AES) Personal, WPA/WPA2 (TKIP/AES) Enterprise, WACL, Hotspot (UAM)

### Antenna

Type	Integrated Dual-Polarized 2.4/5GHz 90° Sector Antenna
Gain	15dBi (5GHz) / 11dBi (2.4GHz)

### Wired

Interface	10/100/1000 Base-T, RJ-45
-----------	---------------------------

### Networking

Operating Mode	Bridge, Router IPv4 and IPv6
Management IPv4	Static, Dynamic
Management IPv6	Static, Dynamic Stateless, Dynamic Stateful
Secondary IPv4	Supported
VLAN	802.1Q for Management and Data
Virtual SSID	8 per radio
Band Steering	Supported

### Traffic Management

Client Isolation	Supported
Wi-Fi Multimedia (WMM)	Supported
Multicast Enhancement	Supported
Concurrent Clients	254

### Services

Services	SNMP server, NTP client, system alerts
----------	--



Discovery Services Bonjour, CDP/LLDP, SSDP

## Power

Power Supply 802.3af/at with Passive PoE (37–56V) Support  
Power Source 100–240VAC to 48VDC PoE (Included)  
Power Consumption 16W

## Physical Specifications

Dimensions 198mm, 198mm, 50,5mm  
Weight 2kg (4.4lb)  
Mounting Pole Mounting Bracket Included

## Environmental Specifications

Outdoor Ingress Protection Rating: IP67  
Surge Protection EN61000-4-5, 10/700µs pulse  
Operating Temperature –40°C (–40°F) ~ +65°C (+149°F)  
Humidity 0~90% (Non-Condensing)

## Management

System Monitoring via SNMP v3, Full Management via External NFT Controller

## Regulatory

Certification CE

## Antenna specifications

### 2.4GHz

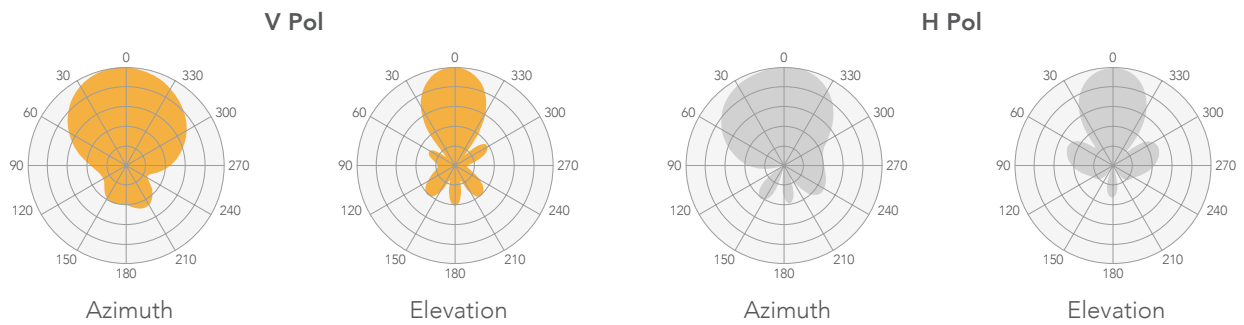

### 2.4GHz Integrated Antenna

Frequency Range	2.4 – 2.5GHz
Gain	11dBi
Polarization	Dual-Linear
Cross-pol Isolation	18dB
VSWR	<2.0, typically 1.5
Azimuth Beamwidth (H-Pol)	90°
Azimuth Beamwidth (V-Pol)	90°
Elevation Beamwidth	36°

### 5GHz

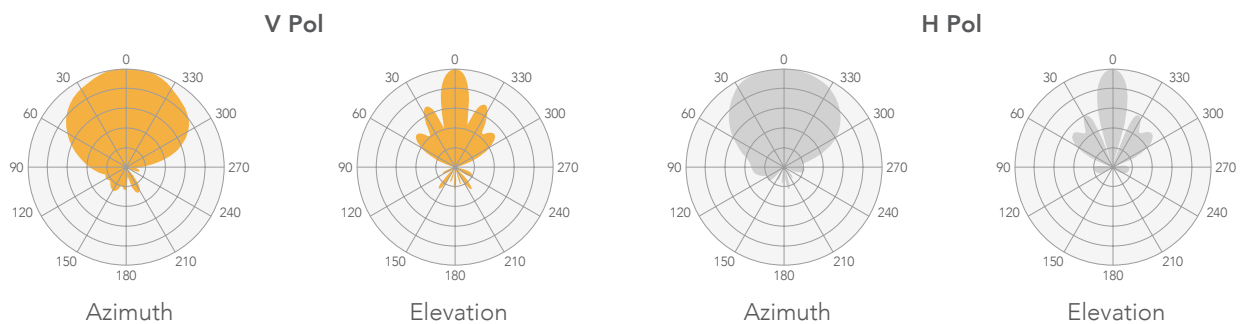

### 5GHz Integrated Antenna

Frequency Range	5.1 – 5.9GHz
Gain	15dBi
Polarization	Dual-Linear
Cross-Pol Isolation	23dB
VSWR	<1.7, typically 1.3
Azimuth Beamwidth (H-Pol)	90°
Azimuth Beamwidth (V-Pol)	90°
Elevation Beamwidth	16°



**LigoWave**

[www.ligowave.com](http://www.ligowave.com)

### **NFT Blizzard 2ac-90**

Copyright © 2018 LigoWave. All rights reserved. LigoWave, the LigoWave logo, are trademarks of LigoWave. All other company and product names may be trademarks of their respective companies. While every effort is made to ensure the information given is accurate, LigoWave does not accept liability for any errors or mistakes which may arise. Specifications and other information in this document may be subject to change without notice. To learn more about LigoWave products, visit [www.ligowave.com](http://www.ligowave.com).